

CHAMPLAIN SPEAKER

March 1997

Vol 16 #8

Changes to the Trees and Birds in the Champlain Park Area : by J. Holliday

For fifty years the trees, shrubs and other vegetation of our area, once known as the "Police Village of Ottawa West", have undergone a slow but evident change.

I don't know when Tunney's Pasture last supported cows, but when the cows left, the "Pasture" started to revert to "forest" where allowed. The Government buildings, manicured lawns and parking lots of course, prevented "forest" from growing in those areas, but in the strips along the Ottawa River and little patches here and there, forest has begun to reclaim the ground.

Fifty years ago these areas were fairly open, with scattered trees, many of them Elms, and many clumps of honeysuckle shrubs. Occasionally there were tangles of Prickly Ash, (one at the river end of Keyworth.) The cows not only ate grasses but also small seedling trees and prevented forest from growing.

Once the cows were gone, seedling trees soon became saplings. The saplings are now trees. Unfortunately, in the 1940's and 50's, Dutch Elm disease attacked the Elms and most of them died and became gaunt skeletons; They decayed and fell down.

Other trees, unaffected by the disease, took their place. Ash and Maple thrived. The swampy area between Champlain School and the river, supported as an understory to the trees, a shrub or small tree called Buckthorn. This "tree" produces fruit in the form of berries which turn purplish black when ripe. Birds, such as Starlings and Waxwings, eat the berries, especially in the winter when food is scarce. The seeds inside the berries pass through the birds' digestive system intact and still viable. The birds' "droppings", here and there, have spread this Buckthorn throughout our area. Especially in damp areas this "tree" is spreading through Southern Ontario.

If you have a hedge that "different-looking" plant, which crowds-out the "Privet" or whatever you planted, is probably a Buckthorn. It will grow and become a problem if not controlled, in between or behind garages, or beside a fence at the edge of property.

This "tree" has become the predominant understory of our wooded areas! That tangle of brush between Pontiac and the river is largely composed of Buckthorn.

The Buckthorn has taken-over much of the open areas. The Haw trees are gone as are most of the Honeysuckles. The few grassy areas are becoming infested with poison-ivy (beware.)

The scattered Honeysuckle which were plentiful 50 years ago, once provided ideal nesting sites for Yellow warblers. Every fifty yards, if there was a Honeysuckle bush, it contained a Yellow Warbler nest.

The open areas provided nesting sites for Killdeer and Sandpipers. Brown Thrashers and Cat-birds built their flimsy-looking nests in the scattered Hawthorn trees. Song Sparrows, Vesper Sparrows and other ground-nesting birds had nests in grassy-weedy areas.

No longer do we see and hear the Yellow-warbler, Brown Thrasher, Cat-bird, Killdeer, and Sandpipers.

The habitat has changed too much for them.

And now the larger trees, Ash, Maple and Oak, are seedlings in amongst the Buckthorn. Probably in the next 50 years (if allowed) they'll grow and supplant the Buckthorn. Not all of it. The Buckthorn is here to stay.

We have new birds too. House Finches are now as common as House Sparrows. Cardinals come to our feeders. (I've seen as many as five at one time). Mourning Doves become more plentiful each year. And then there are the Gulls. Once uncommon, they thrive on the food we pile in our "dumps" (excuse me, sandfill areas.) Mostly Ring-Billed Gulls nest on the islands in the Ottawa River near Lemieux Island and the rocky areas on the Quebec side above the Chaudiere Falls. Their numbers increase yearly. I'd "guesstimate" there are 100,000 Ring-Billed Gulls in the Ottawa Area in summer months. (They go south in November and will rejoin us in March.) And have you noticed our Black Ducks are being replaced by Mallards?

Canada Geese, which 25 years ago we saw flying overhead in April-May on the way to their nesting grounds in the Arctic, now nest locally and can be hand-fed in September along the river at the end of Carleton Ave (they like bread).

You may be interested to know that the Yellow-warblers are parasited by the Brown-Headed Cowbird. The Cowbirds, it is supposed, once flocked around the great herds of Bison (Buffalo) which roamed the Prairies of North America. Their method of livelihood was to travel with the Bison and to feed on the insects which moved out of the way of the Bison to avoid being stepped upon. Constantly on the move, it was difficult for the Cowbirds to maintain a nested family. To solve this problem, the Cowbirds laid their eggs in the nests of other birds, and allowed the other birds to raise the young Cowbirds. This practice was successful and the Cowbirds, which on forage around the feet of Cows, still lay their eggs in other birds nests.

Among those nests are those of the Yellow-warbler. The Yellow-warbler, however, objects to raising Cowbirds, much preferring to raise Yellow-warbler. The Cowbird watches and when the Warbler leaves the nest to feed, the Cowbird quickly drops her egg into the nest. Mrs Warbler, on her return, is consternated to discover the strange egg in among her own. Unable to remove the offending egg, the Warbler frequently builds a new nest on top of the first nest, in doing so, burying the Cowbird egg, and her own eggs too.

Sometimes a Cowbird drops an egg into the second nest. Not to be undone, the Warbler then builds a third nest on top of nest #2. Sometimes the Cowbird ditto, and the Warbler ditto. I have found five nests stacked, four on top of the original. Each of the buried nests contained a Cowbird egg, some of them also had Warbler eggs.

I found the nest in winter, and so, I don't know which of the birds had the last laugh (or egg.)

You may have noticed that there are a few Black



(continued on page 2)

Champlain Speaker Newsletter Staff

Newsletter Editor: Sue Robertson 724-5871
 Layout/Calendar: Barb Robertson 729-5439
 Distribution: Neil Robertson 729-5439
 Carriers: Shelley Cornelius, Kay Young, Sandy Milne
 Philip Cutfield, Patrick Mates, Jim Croft, Laura Robin, Becky Rynor, Jean Wevill, Wendy Huculak, Heather Pearl, Monique Kerr, Carole Anne Copeland, Linda Steele, Beth Buist, Nancy Leigh-Smith, Karen Maser, Marlene Kells, Jackie Crawford.

Champlain Community Association Executive

President: Tim Frank 729-0882
 Vice-president: Amy Kempster 722-6039
 Secretary: Laura Muldoon
 Treasurer: Kay Young 722-7955
 Special Events: Laurie Fagan 728-1945
 Membership: Jim Cocks 728-7881
 Neighbourhood Watch: Michael Cheng 722-3344

T'ai Chi

Intermediate/Beginners T'ai Chi: T'ai Chi is a system of exercise to improve your balance in both body and spirit and to teach good breathing. Mr. Hoa Ba Tran has offered to teach a T'ai Chi class at 8:00 to 9:00 p.m. on Wednesday evening. He is an experienced teacher of classic T'ai Chi. To master this art takes patience and practice, so come and learn with us. The class will commence Mar. 26 for 10 weeks ending May 28.
 Cost: \$35.00 for member, \$40 for non-members
 Time: 8:10 to 9:15 p.m., Wednesdays, Mar. 26 to May 28.
 Place: Champlain Park Field House, Cowley near Clearview. Register by telephone by Mar. 24 with Amy Kempster, 722-6039. Class limited to 15, minimum 4.

Sue's Word Find

N P T Y A D S N A M O W L T N I
 I M A X F H F L O O D S I S Y D
 A A G L O I S D R I B P M H A E
 R R O N M N N E R O L R H A D S
 Y C O O I S I D R E T I T M N O
 A H D I O N U U Y F Y N R R O F
 D B F T S P I N Q A E G I O M M
 S R R A D L N A D E A N B C R A
 H E I R U U H S R A L E E K E R
 P A D G B S D G S T Y A R S T C
 E K A I U I L Y L G G P N O S H
 S W Y M V U A E R G G N U R A A
 O A S A D U M T N U H E I R E R
 J H D D A L B A N E I L E R I V
 T T Y A D N U S R E T S A E P M
 S T P A T R I C K S D A Y E N S

St Patrick's Day, St David Days, St. Joseph's Day, Vernal Equinox, Alban Eiler, Int'l Woman's Day, Ides of March, Palm Sunday, Purim, Easter Monday, Easter Sunday, March Break, Migration, Green, Lion, Lamb, Melt, Smush, Spring Training, Good Friday, Spring, Rain, Thaw, Birds, Mud, Fresh, Rebirth, Eggs, Bunny, Shamrocks, Leek, Floods, Buds, Hunt, Find, Lore.

Answer to last month's puzzle was:

Surprise Your Special One

(continued from page 1)

Walnut trees in the neighbourhood. Clarence Mould, on Keyworth, has two mature trees on his property. He has a sort of love/ hate feel for these trees.

When the filtration plant was built on Lemieux Island in the 1920's-30's, someone planted a number of Black Walnut trees as part of the landscaping. Suspicion is that the Walnut trees on Keyworth, Western, Caroline and Spencer are grown from the nuts of the Lemieux Island trees.

Squirrels have robbed Clarence of a number of nuts and planted them here and there. This species apparently needs good light to be successful, and so they are usually found growing on the edge of the woods. There is one near the gate at the corner of Pontiac and Carleton; two just inside the fence corner of Keyworth and Pontiac and several inside the fence across from the school yard on Patricia.

And of course the Oaks are the pride of our area. Here long before us, some are 200 yrs old, they tower over the neighbourhood providing food for the pesky squirrels and shade for us all in the summer. Most of these are Burr-Oaks.

Those of us who walk about the neighbourhood can watch (and listen) for the Cardinals and House Finches even in winter. The best place to look for migrating warblers is along the path through the woods at the end of Keyworth.

We can admire the many lovely trees, the Oaks and Lindens, the Maples and Ash. Also we can look at the "special" trees of the neighbourhood: the surviving American Elm in front of the school on Pontiac; the Catalpa on Clearview at I.P.D.; Harry Honey's late to leaf tree (an Acacia); the Hockberry on Keyworth; the large chinese Elm on Sunnymede near Cowley; the Horse Chestnut at 201 Keyworth; and I've even seen a Ginko but I can't remember where.

And we can't help but notice the ever spreading Buckthorn which is effecting the biggest change in our local "forest".

*Buckthorn and introduced species, from Europe.

from the
EDITOR



Is it just me, or do other people feel like they are being held hostage in one of those tacky little tourist souvenirs? You know the kind - it has a winter scene or a Mounty and the Parliament Buildings in a bubble and when you shake it "snow" cascades down inside it. Perhaps I am suffering from a bit of cabin fever.

Yes, it is now March. Yes, there are only three more weeks until spring is officially here. After this past winter, a collective round of applause goes out to Tom Sauvé and the numerous volunteers who helped to get and keep the rink operating this winter. A winter like the one just past must have made the job more challenging, but the hours of work and dedication were enjoyed by all who used the rink.

Sue

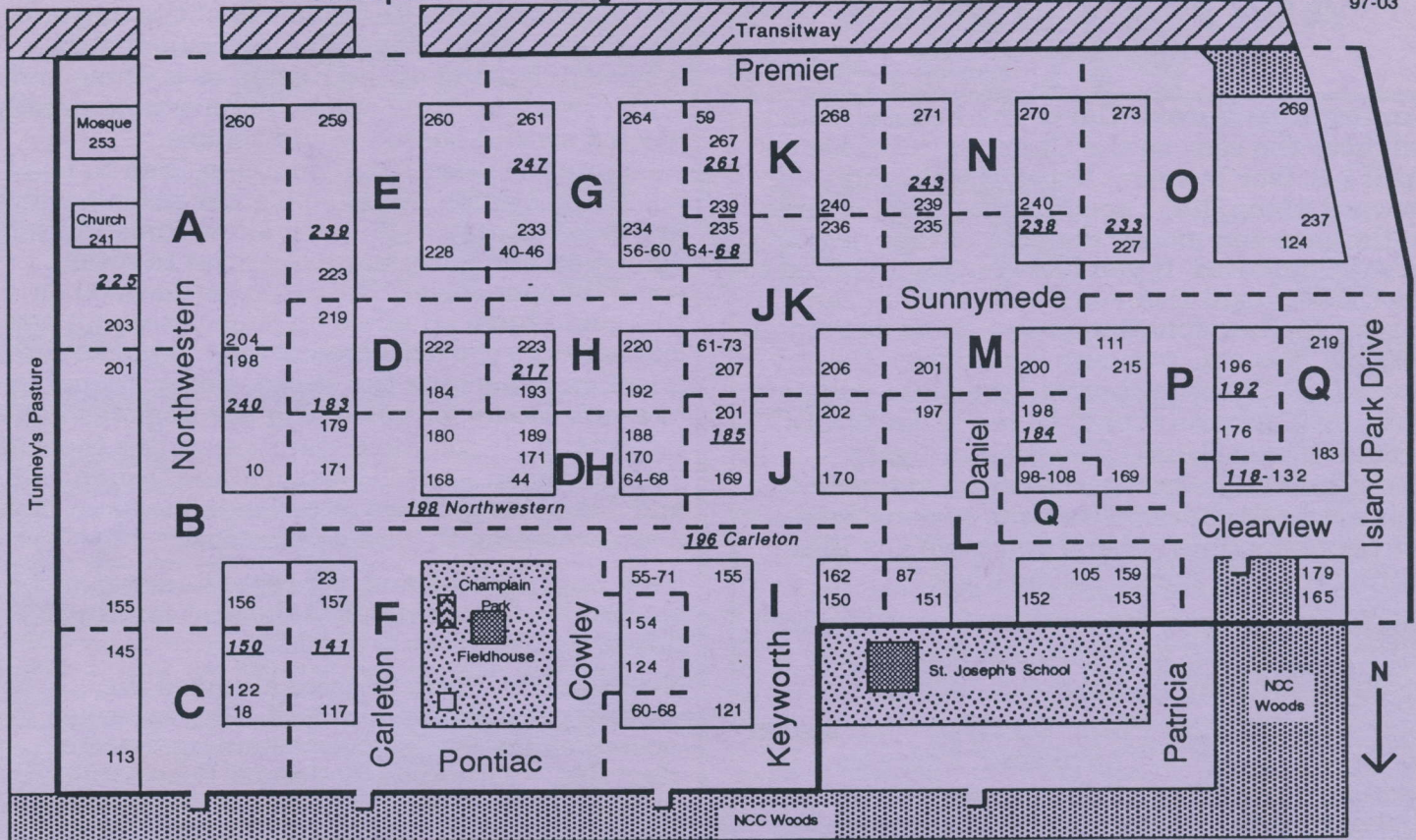

The addresses of block captains are **highlighted**.

Block	Area Covered	Block Captain	Address	Telephone
A	203-253 & 204-260 Northwestern.	Brian Cornelius	225 Northwestern	729-6525
B	155-201 & 156-198 Northwestern, 10 Clearview.	Carole Johnson	240 Northwestern	729-8873
C	113-145 & 122-150 Northwestern, 18 Pontiac.	Charlotte Wilson-Miller	150 Northwestern	761-1101
D	183-219 & 184-222 Carleton.	Lynne Bankler	183 Carleton	729-0955
DH	171-179 & 168-180 Carleton, 171-189 & 170-188 Cowley, 44-68 Clearview	Jackie Crawford	198 Northwestern	798-7342
E	223-259 & 228-260 Carleton	John Texeira	239 Carleton	725-9463
F	117-157 Carleton, 124-154 Cowley, 23 Clearview and the Park	Nick Montero	141 Carleton	728-7545
G	233-261 & 234-264 Cowley, 40-60 Sunnymede.	Carol Arnason	247 Cowley	729-6639
H	193-223 & 192-220 Cowley.	Jacques Bourbeau	217 Cowley	728-0337
I	121-155 & 150-162 Keyworth, 55-71 Clearview, 60-68 Pontiac.	Jo-Ann Benn	196 Carleton	729-1346
J	169-201 & 170-202 Keyworth.	Verne Potvin	185 Keyworth	725-5423
JK	207-235 & 206-236 Keyworth, 61-73 & 64-68 Sunnymede.	Tom Sauve	68 Sunnymede	728-0191
K	239-267 & 240-268 Keyworth, 59 Premier.	Lee Scott	261 Keyworth	729-3035
L	151-197 & 152-198 Daniel, 87-105 Clearview, 153-159 Patricia.	Evelyn Sparks	184 Daniel	728-5552
M	201-235 & 200-238 Daniel.	Carole Copeland	238 Daniel	729-7824
N	239-271 & 240-270 Daniel.	Helen Joseph	243 Daniel	722-4088
O	227-273 Patricia, 237-269 Island Park, 124 Sunnymede.	Lynda Fancy	233 Patricia	725-1315
P	169-215 & 176-196 Patricia, 111 Sunnymede.	Karen Maser	192 Patricia	722-6700
Q	98-132 Clearview, 165-219 Island Park	Amy Kempster	118 Clearview	722-6039



FOR EMERGENCY CALLS, DIAL 911
For non emergency situations, call 236-1222

District Police Office, 418 1/2 Richmond Rd.
Contact: Constable Samir (Sam) Bhatnagar
Telephone: 236-1222, ext 5871

Supervisor: Sgt. Terry Welch, ext 5876

It is our responsibility to;
§ make our homes secure
§ watch our neighbour's property
§ report any suspicious activities to the police

Your coordinators are:
Michael Cheng, 145 Carleton Ave., 722-3344
Nick Montero, 141 Carleton Ave., 728-7545

AMY'S CORNER

Amy Kempster 722-6039

Community before Cars: The Federal Court will hear the case on the Champlain Bridge on April 1-3. Our lawyers, Roger Harris and Howard Mann, have spent a great deal of time on the case and money donated earlier needs to be supplemented. If you have not yet donated to the CBCC Legal Defence Fund or if you can spare a further donation please do so as soon as possible. You can drop any donations off at my house (118 Clearview) or call me and I will pick them up (Cheques should be made out to CBCC Legal Defence Fund). The fund is legally incorporated as a non-profit organization but does not have charitable status so donations are not tax-deductible. Also if you have any ideas for fund-raising please let me know.

Regional Budget: No tax increase this year but there are dire warnings about next year because of the provincial downloading.

Regional Official Plan: The draft Plan seems fairly good as far as I have read. There may be some problem with urban greenspace. Greenprint, FCA (Federation of Citizens' Associations of Ottawa-Carleton) and the Region are holding a workshop on Saturday, March 22 at 9:00 A.M. to discuss the Region's proposed policies and designations for Natural Environment and Regional Open Space and Cultural Heritage. If you are interested in the future of natural areas and greenspace in the Region, please attend. While the NCC property near us is indicated as waterfront open space many other valuable green spaces, such as Hampton Park, are included in the general urban area. For an overall view of the draft Official Plan, attend one of the information sessions to be held in Ottawa on March 25 at City Hall, Guiges-Freiman Rooms from 5-8 P.M. and on April 7 at RMOCC Ottawa-Carleton Centre, 111 Lisgar Street Rotunda from 4-7 p.m. with a presentation at 7 P.M. The Official Plan will determine the location for growth in the region and could affect all neighbourhoods. Make your plans now to attend.

One-Tier?: The Forum on this on Feb. 24 seemed to indicate a desire for a more public process such as a constituent assembly or deliberative polling. The motion being put forward by Regional Councillor Brian McGarry would lead to a process somewhat divorced from sitting politicians and might be a solution to obtain public input. The plan put forward by the 10 mayors (not including Holzman) would use service boards to handle what will probably be at least 80% of our taxes (after downloading by the province)! My experience of watching

Regional Council is that the change to directly elected councillors and removal of the mayors has meant a better functioning council more geared to looking at the Region as a whole and with fewer parochial spats. To have non-directly elected service boards would reduce accountability and, in my opinion, lead to more fractiousness. There may be other models which are more attractive but still allow some scope for suburban and rural municipalities to retain some independence. The ultimate decision on this could have an effect on your taxes and how city services are delivered so your input to the question of keeping the status quo or changing to a new model for governing the Region will be important. If you have opinions on this topic let your Regional and City Councillors (Linda Davis and Joan Wong) know or perhaps we could have a local meeting to discuss the topic.

New Zoning By-Law: We requested that we be allowed to give our input at the next meeting on this topic, Mar.25 at 1:15 P.M.

NOSS study: Patrick Mates attended the workshop for Champlain Park. The workshop focused on the feasibility of retaining the sites identified. Our woods, St Joseph' School and Champlain Park were included in the preliminary list of sites.

Variance for the Mosque: Reminder! The hearing will take place March 6. If you have concerns about this call me.

NEWSWEST: Most of you receive NEWSWEST at your door. It is a non-profit community newspaper for most of the west end of Ottawa. However, currently no one delivers on Daniel Avenue. How about a volunteer for Daniel? Call me (722-6039) or NEWSWEST (728-3030) if you can spare an hour or two once a month to deliver NEWSWEST. As well we could report news of our community activities such as Winterfest in NEWSWEST if someone would volunteer to submit it.

NATURE CORNER

You were right that little owl was sitting right in the middle of the picture. This snap was taken down in the Champlain Woods. Saw-Whet Owls are one of several species that will seek shelter in wooden nest boxes. An owl cannot digest bones, fur, and other hard items. They regurgitate them several hours after eating. You will find these pellets on the ground where the owl roosts.



Photo by
J. Holliday

MARCH/97

SUNDAY

MONDAY

TUESDAY

WEDNESDAY

THURSDAY

FRIDAY

SATURDAY

2	3 Playgroup 9:30-11:30 a.m. <i>Social Group meets at Fieldhouse 2 to 4 pm</i> Aerobics Class 7-8 p.m.	4 Playgroup 9:30-11:30 a.m. <i>Fly Fishing</i> 7:00 p.m.	5 Aerobics Class 7-8 p.m. T'ai Chi 8:10-9:15 p.m.	6 Playgroup 9:30-11:30 a.m. Yoga 7:30-9:00 p.m. Mosque Variance	7 BLUE BOX	8
---	--	--	---	---	-------------------	---

9	10 Playgroup 9:30-11:30 a.m. <i>Social Group meets at Fieldhouse 2 to 4 pm</i> Aerobics Class 7-8 p.m. Fly Tying 9:00 p.m.	11 Playgroup 9:30-11:30 a.m. Garden Club Meeting 7pm	12 Aerobics Class 7-8 p.m. T'ai Chi 8:10-9:15 p.m.	13 Playgroup 9:30-11:30 a.m. Yoga 7:30-9:00 p.m.	14 BLUE BOX	15 Hazardous waste opens at Trail Road Saturdays 9-5
---	---	--	--	--	--------------------	--

16	17 Playgroup 9:30-11:30 a.m. <i>Social Group meets at Fieldhouse 2 to 4 pm</i> Aerobics Class 7-8 p.m. ST. PATRICK'S DAY	18 Playgroup 9:30-11:30 a.m. <i>Fly Fishing</i> 7:00 p.m.	19 Aerobics Class 7-8 p.m. T'ai Chi 8:10-9:15 p.m. Irish Dinner 5 p.m. Northwestern United Church	20 Playgroup 9:30-11:30 a.m. Yoga 7:30-9:00 p.m.	21 BLUE BOX	22 Official Plan Workshop 9:00 a.m.
----	--	---	--	--	--------------------	--

23 Palm Sunday	24 Playgroup 9:30-11:30 a.m. <i>Social Group meets at Fieldhouse 2 to 4 pm</i> Aerobics Class 7-8 p.m. Fly Tying 9:00 p.m.	25 Playgroup 9:30-11:30 a.m. Info Session Official Plan 5-8 p.m. City Hall Zoning By-law input	26 Aerobics Class 7-8 p.m. T'ai Chi 8:10-9:15 p.m.	27 Playgroup 9:30-11:30 a.m.	28 Good Friday	29 GARBAGE & BLUE BOX
----------------------	---	--	--	------------------------------------	----------------------	--

APRIL/97

30 Easter Sunday	31 Playgroup 9:30-11:30 a.m. <i>Social Group meets at Fieldhouse 2 to 4 pm</i> Aerobics Class 7-8 p.m. Easter Monday	1 Playgroup 9:30-11:30 a.m. <i>Fly Fishing</i> 7:00 p.m.	2 Aerobics Class 7-8 p.m. T'ai Chi 8:10-9:15 p.m.	3 Playgroup 9:30-11:30 a.m.	4	5 GARBAGE & BLUE BOX
------------------------	--	--	---	-----------------------------------	---	---

***Playgroup will run every Monday, Tuesday and Thursday from 9:30 a.m. to 11:30 a.m.
 ***Aerobics Class Monday & Wednesday evenings, 7-8 p.m. for 19 weeks, Jan. 6 to May 14, 1997.
 ***T'ai Chi Classes Wednesday evenings, 8:10-9:15 p.m. for 10 weeks, Mar 26 to May 28, 1997.

TO ADD ITEMS NEXT
MONTH - CALL 729-5439

ANNOUNCEMENTS

Local Teens Interested in Work:

Tom Arnason	729-6639	Snow Shoveling
Rachelle	722-6303	Babysitting
Jessica	728-8413	Babysitting
Sarah	722-2687	Babysitting
Paul Ratsch	728-2583	Snow Shoveling
Rory Taylor	798-0036	Snow Shoveling

PENNYSAVER CHANGES

By now you are probably aware that there has been a change in your Pennysaver delivery. The official line from Netmar is that the change was made to provide a uniform delivery time throughout the region. Until now we have been fortunate to receive the Pennysaver on Saturday while other areas have not received it until Sunday. Officially, it will now be delivered everywhere between 5 pm Saturday and noon Sunday. Unfortunately, none of the carriers in Champlain Park are able to accommodate this new schedule and have, therefore, relinquished their routes.

We undertook these routes to ensure that at least some of the flyers delivered in this area would arrive dry, intact and not end up decorating the neighbourhood or flagging the absence of residents. Our desire was to disturb our neighbours as little as possible. We appreciate the support that you have given us and we thank you.

Our concern is that the Pennysaver may now be delivered by contractors who do not live in the area and that the quality of delivery will deteriorate. This could also compromise neighbourhood security. If you have any comments, please do not hesitate to call Netmar at 723-1717 or fax them at 723-7186.

Barb, Neil, Sue and Kim Robertson.

Northwestern United Church

Irish Dinner on Wednesday, March 19, 1997 at 5:30 p.m. Adults \$8.00 children \$5.00. Entertainment at 7:00 p.m. by the Dougherty Dancers.

Sunday, March 23, Palm/Passion at 10:30 a.m.

Sunday, March 30, ***Easter*** at 10:30 a.m.

Ottawa West Community Support: Income Tax service for seniors. During the months of March and April. Call Rita at 728-6016 for appointment.

The Champlain Park Garden Club Meeting

Celebrate the arrival of Spring as the Champlain Park Garden Club proudly presents Anne Ginns. Our guest speaker will take us through the steps involved in our spring garden so that we might have flowers during the summer from bulbs. The meeting is on Tuesday, March 11 at 7:00 p.m. at the Champlain Park Fieldhouse. Door fee of \$5.00 for non members. Have you started your seeds yet? Only 90 days left until the Plant and Seed Exchange! (Saturday May 31)

GIVE SOMEONE A SECOND CHANCE

March is Kidney Month. Please give generously.
THE KIDNEY FOUNDATION OF CANADA

PET CORNER

Worms, worms, worms!

Inevitably, the receding snow leaves a trail of pet poop that has accumulated over the winter. Since intestinal parasite eggs can withstand freezing, any contaminated poop will be liberating eggs into the surrounding area. Eggs can adhere to the fur of dogs and cats walking in these areas, and then become ingested as the pet cleans its fur. For roundworms, these eggs can become adult worms within three weeks and begin laying their own eggs. Although pets may show no clinical signs with low worm burdens, higher numbers can cause diarrhea, unthriftiness, and weight loss. Eggs can also infect people, usually children, reinforcing the need for good hygiene.

To avoid roundworm or other worm problems, have your pet's stool sample checked at least once a year, and consider some type of preventative medication. Once a month heartworm preventative pills are available that also prevent many intestinal parasites. Avoid taking your pet to areas of obvious contamination such as those areas of parks that all the dogs like to use.

Finally, practice good personal hygiene by washing your hands after handling your pet.

Courtesy of the Bayview Animal Hospital
101A Champagne Ave. S., 728-5852

Something to think about if you frequent the Champlain Woods. The oil from the *Poison Ivy* also adheres to your pets' fur and can be transferred to humans. Just ask me! Neil Robertson

FISHER PARK C.R.C.

Spring Ball Registration

April 2 & 3 6:00 - 8:00 p.m.

April 5 9:00 a.m. - 12:00 p.m.

Fisher Park Public School Small gym

For more information call 798-8945

No early or phone registrations will be taken

Yes Its' Spring !! And It's not too Late to Shape Up.

Join the second half of our spring aerobics session. The classes run every Monday and Wednesday evenings, 7-8 until May 14/97 at the Fieldhouse, corner of Cowley & Clearview.

Patricia Cianci and Julie Vout are instructing.

Cost \$42.

To Register, call Liz at 728-7160 or come to the class.

Thank you

I would like to thank everyone who made the 1997 winter Carnival a big success. Mother nature co-operated for the most part. Thanks to Jim Cocks, Brian Cornelius, Tim Frank, Evelyn Sparks, Ann Doswell, Jacques Bourbeau, and many others. I'd especially like to thank Kelly and Will Egan. for all their help. Once again I encourage new people to please come forward and volunteer. Community events only thrive when new volunteers replace the dedicated but weary stable of community minded people. Thanks again.

Laurie Fagan